

3 Bed (4P)

- Apartment Area 80.8sq. m (76sq. m minimum required)
- Aggregate Living/Dining/Kitchen area 31sq. m (34sq. m minimum but variation of up to 5% can be applied to room areas subject to overall compliance with required minimum overall floor area)
- Storage Area 6sq. m (6sq. m minimum required)

L01 - Apartment Type A
1 : 50

Block C L00-L07
Block B L01-L11

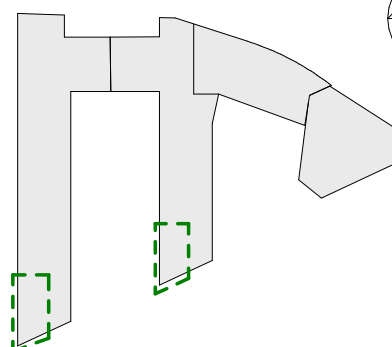

Notes:

- Do not scale from this drawing. Use figured dimensions in all cases.
- Verify dimensions on site and report any discrepancies to the Architect immediately.
- This drawing to be read in conjunction with the Architect's Specification.
- © This drawing is copyright and may only be reproduced with the Architect's permission.

P01	20.03.2026	RAU	Issued for Planning
Rev.	Date	Drwn	Details of Issue / Revision

Issues & Revisions



Dartry Mills,
Dartry Road
Dublin 6,
D06 Y0E3
T: +353 (0)1 498 7000
W: www.reddyarchitecture.com
E: info@reddyarchitecture.com

Client Details:

Ruiside Developments Ltd.

Project Details:

**Parkgate St.
42a Parkgate St, Dublin 8**

Drawing Title:

Application 02 - Proposed Apartment Type A

Job No. P24-216D	Sheet Size: A1_	Scale @A3
Issue Date: 20.03.2026	Drawn By: RAU	Reviewed By: PK
Status S0	Purpose of Issue Planning Permission	
Project - System - Spatial Zone - Level - Type - Originator - Role - Number		Revision
PGS-02-SW-ZZZ-DR-RAU-AR-5001		P01